

PLAN NO 568  
 FOR THE IMPROVEMENT OF  
**PRATT STREET**  
 BETWEEN  
 BASE LINE STREET & THIRTEENTH STREET  
 IN THE  
 CITY OF SAN BERNARDINO  
 Jan 20 1928  
 Scale 1"=40'

*Ed*



All elevations are in feet and inches  
 unless noted as otherwise by the  
 Ordinance No 282 of the City of San  
 Bernardino

**PROFILE**  
 Black Lines Show Present Surface  
 Red Lines Show Established Grade

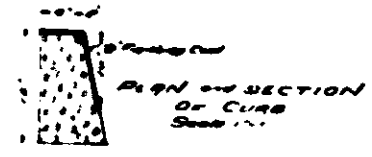
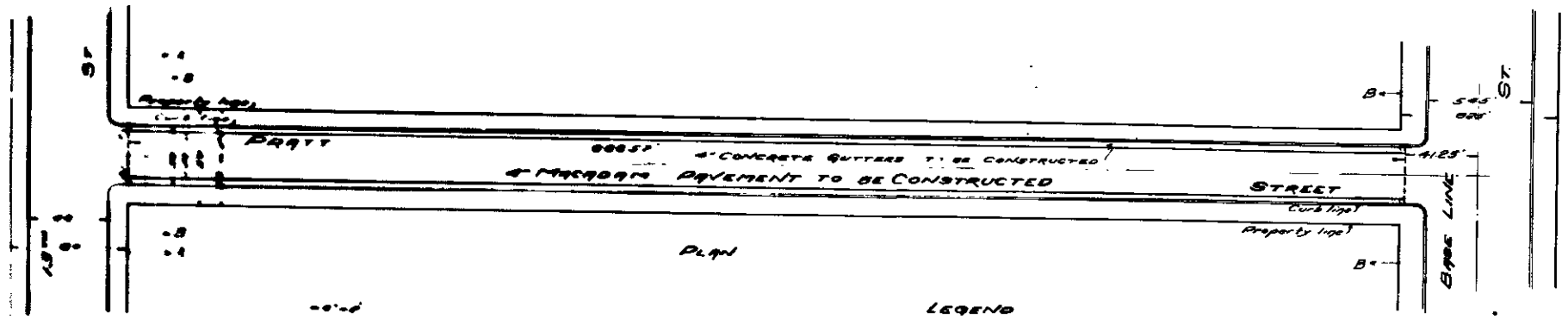

**LEGEND**  
 1/4" or 1/2" means 1/4" or 1/2" of ft. means feet or feet  
 No. means number  
 St. means Street  
 E.L. means existing  
 Macadam pavement to be constructed shown thus  
 Concrete gutters to be constructed shown thus  
 Concrete gutters in section shown thus

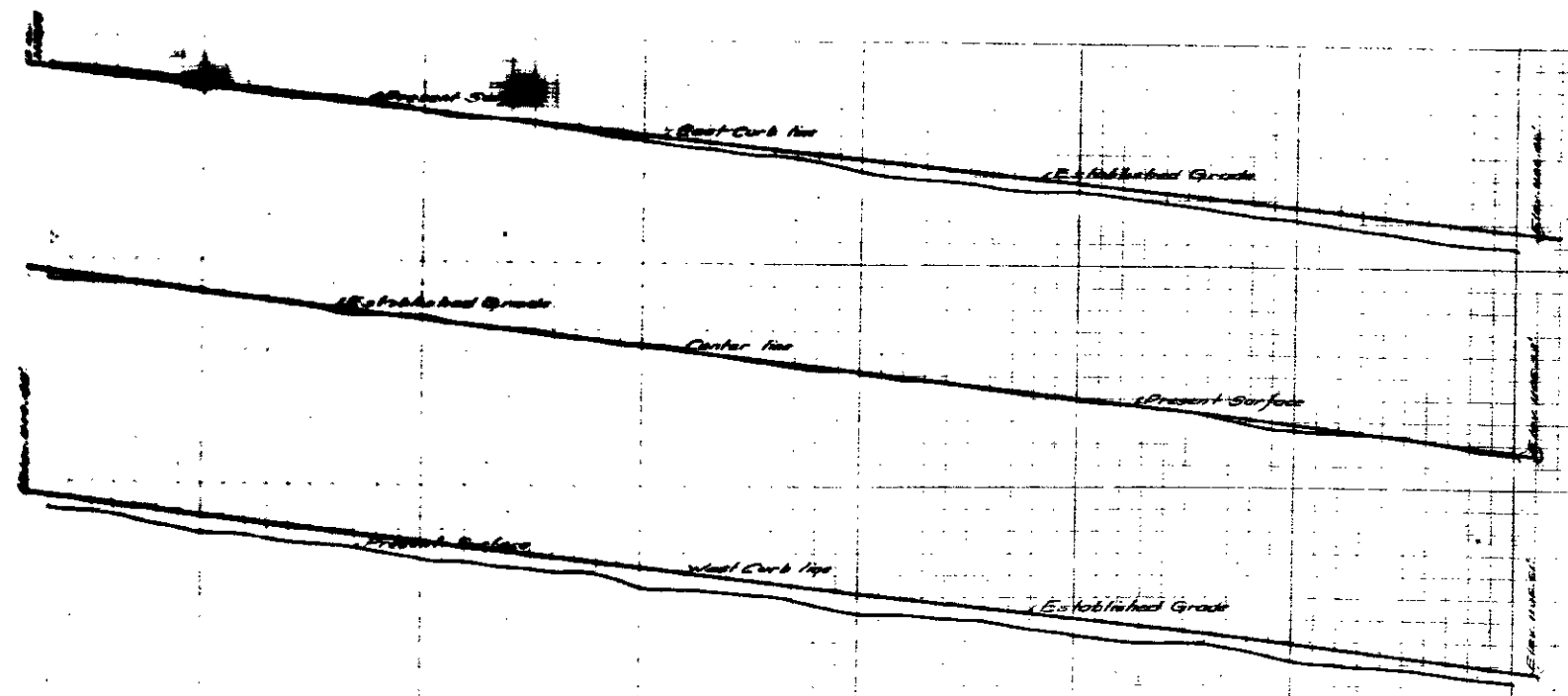
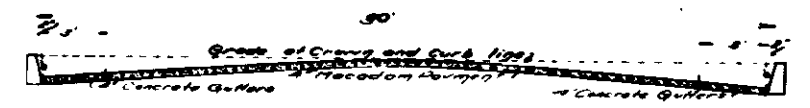

PLAN NO 568  
 FOR THE IMPROVEMENT OF  
**PRATT STREET**  
 BETWEEN  
 BASE LINE STREET & THIRTEENTH STREET  
 IN THE  
 CITY OF SAN BERNARDINO  
 Jan 20 1928  
 Scale 1"=40'

*Ed*



All elevations are in feet and inches  
 unless noted as indicated by the  
 Ordinance No 282 of the City of San  
 Bernardino

PROFILE  
 Black Lines Show Present Surface  
 Red Lines Show Established Grade

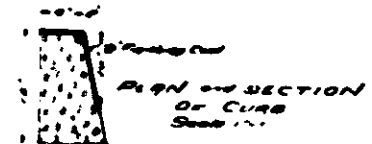
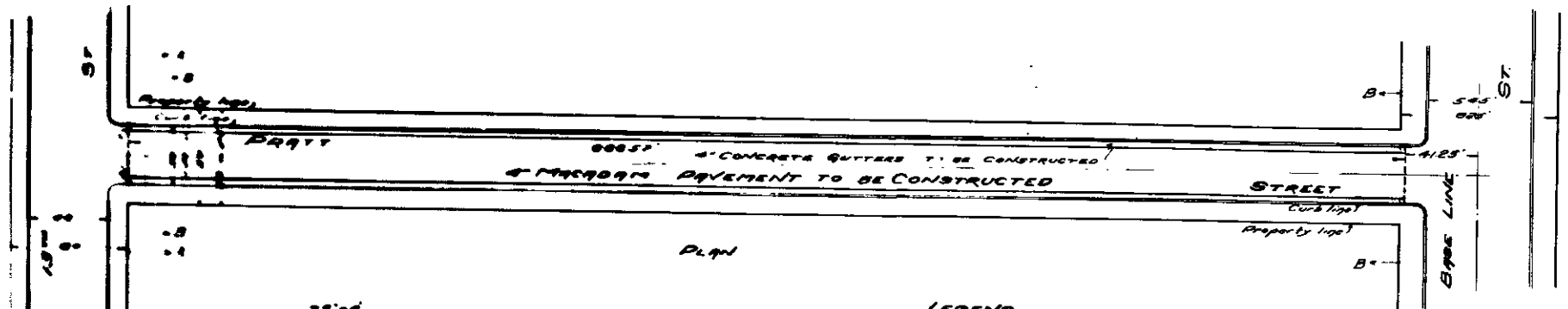

LEGEND  
 1" or 2" means 1 inch or 2 inches  
 1/2" means 1/2 inch  
 1/4" means 1/4 inch  
 1/8" means 1/8 inch  
 Macadam pavement to be constructed shown thus  
 Concrete gutters to be constructed shown thus  
 Concrete gutters in section shown thus

